

# STUD TYPE TRACK ROLLERS FULL COMPLEMENT SEALED DOUBLE ROW PWKR SERIES

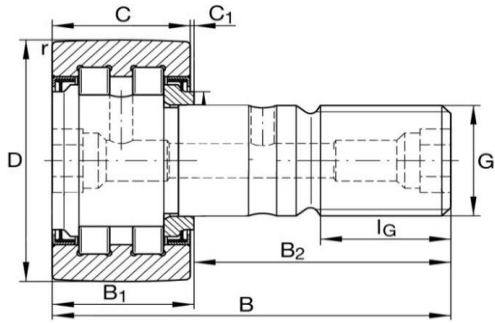

Part Number	Roller Stud Diameter G	Outer Diameter D	Outer Ring Width C	Outer Ring Washer Protrusion C1	Outer Ring Width with Washers B1	Total Length B	Bolt & Stud Length G	Thread Length lG	Bolt & Stud Length B2	Tightening Torque Nm	Dynamic N	Static N	Speed (grease) rpm	Weight kg
PWKR35-2RS	16	35	18	0.8	19.6	52	M16x1.5	17	32.5	58	12100	14300	6000	0.164
PWKR40-2RS	18	40	20	0.8	21.6	58	M18x1.5	19	36.5	87	14900	17800	5000	0.242
PWKR47-2RS	20	47	24	0.8	25.6	66	M20x1.5	21	40.5	120	23600	30400	3800	0.380
PWKR52-2RS	20	52	24	0.8	25.6	66	M20x1.5	21	40.5	120	24600	32400	3800	0.530
PWKR62-2RS	24	62	28	1.3	30.6	80	M24x1.5	25	49.5	220	33600	43000	2200	0.795
PWKR72-2RS	24	72	28	1.3	30.6	80	M24x1.5	25	49.5	220	38200	51600	2200	1.020
PWKR80-2RS	30	80	35	1	37	100	M30x1.5	32	63	450	55300	74300	1800	1.600
PWKR90-2RS	30	90	35	1	37	100	M30x1.5	32	63	450	60700	86600	1800	1.960

All Dimensions in mm

The PWKR series are double row and sealed, full complement Stud Type Track Rollers. They have a profiled outer ring and grease facility in the stud section. They should be axially secured using a hexagon nut. Correct tightening torque for the fixing nuts should be followed to ensure that the full radial load can be achieved, but if self-locking nuts are used - then the tightening torque from the nut manufacturer should be followed.

